

## CLASSE H4 BORDO PONTE - BARRIERA 3 ONDE PER MANUFATTO W5

Class H4 Bridge side - 3-waves guardrail for bridge W5  
 3 Wellen Leitplanke auf Bauwerk, Aufhaltestufe H4, Wirkungsbereich W5  
 Classe H4 Bord pont - Glissière 3 ondes simple pour pont W5  
 Clase H4 Borde de puente - Barrera de triple onda simple para base puente W5

# H4-W5

## 3-waves

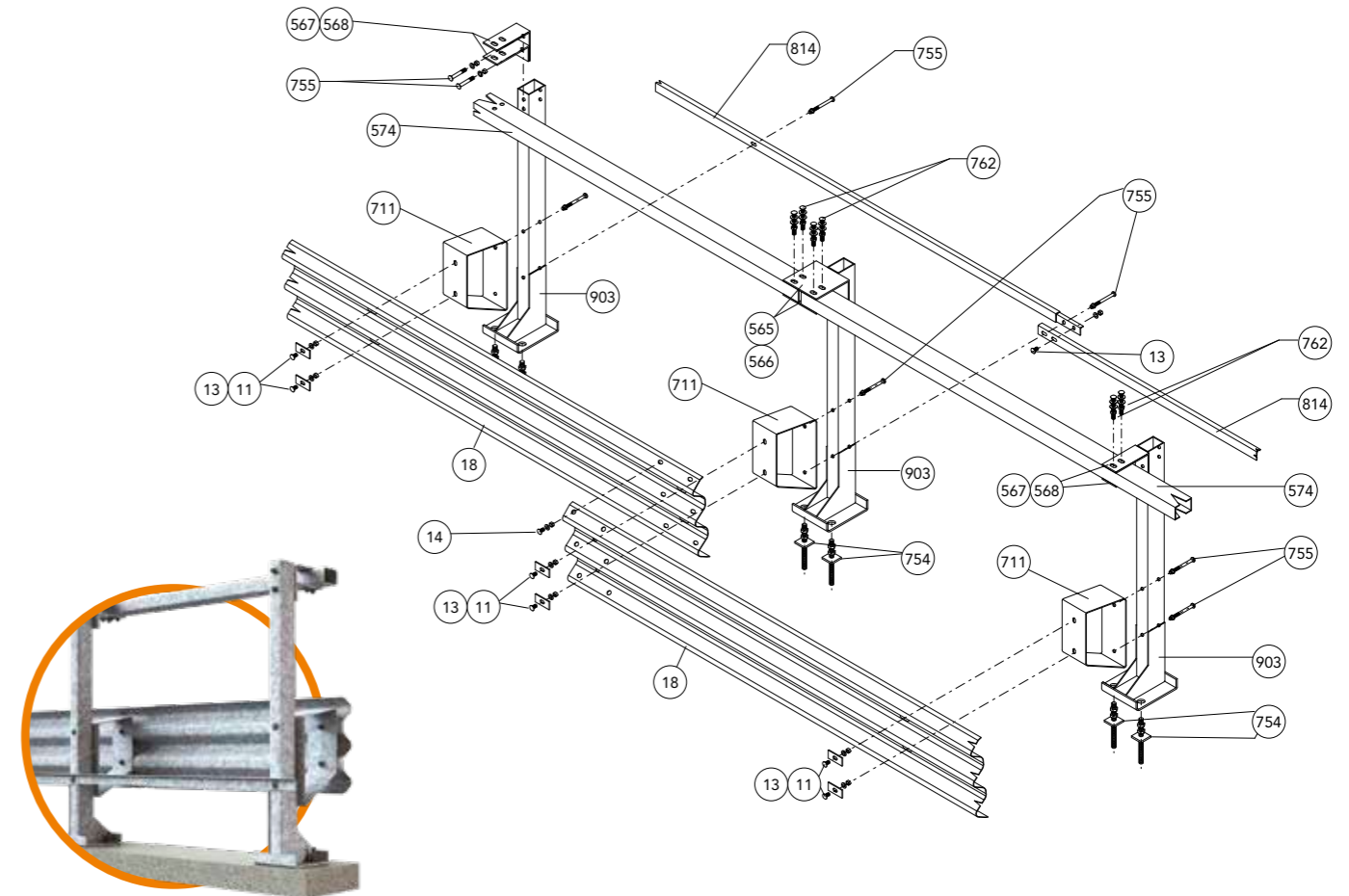
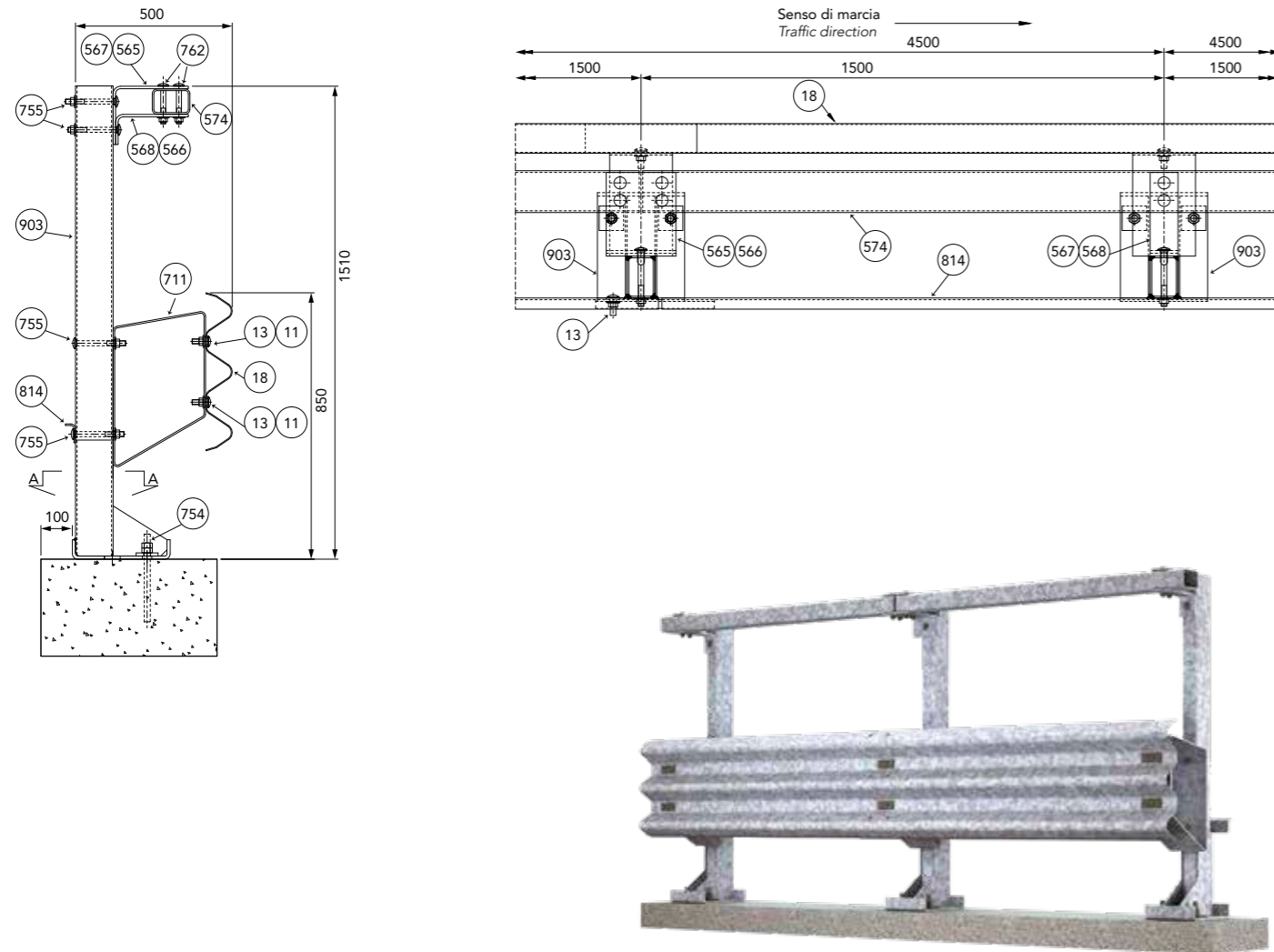

### Componenti Components, Bauteile, Componentes, Elementos

Descrizione Description		Materiale Material
755		M16x160 mm Classe 8.8
762	<b>Bullone completo</b> Bolt with nut and washer, Schraube komplett,	M16x130 mm Classe 8.8
13	<b>Boulon complet</b> , Tornillo completo con tuerca y arandela	M16x50 mm Classe 8.8
14		M16x30 mm Classe 8.8
754	<b>Tirafondo + dadi + 1 rondella</b> Anchor bolt + nuts + 1 washer, Verbundklebeankerschraube + Mütter + 1 Unterlegscheibe, Tire-fond + écrous + 1 rondelle, Varilla Roscada + tuercas + 1 arandela	M20x280 mm Classe 8.8
11	<b>Piastrina copriasola</b> Slot covering plate, Lochabdeckplatte, Plaque de couverture fente, Placa cubre-ranura	100x40x4 mm S 275 JR
814	<b>Tirante posteriore (angolare)</b> Rear reinforcement (angle profile), Hintere Zugstange (Winkelprofil), Renfort arrière (angulaire), Tirante trasero (angular)	60x35x5 L=4680 mm S 235 JR
568		80x309.7x8 mm S 275 JR
567		80x407.7x8 mm S 275 JR
566	<b>Distanziatore del tubo corrimano</b> Spacer for handrail, Abstandhalter Handlaufrohr, Entretoise rambarde, Separador del tubo pasamanos	200x309.7x8 mm S 275 JR
565		200x407.7x8 mm S 275 JR
711	<b>Distanziatore romboidale</b> Rhomboidal spacer, Rhomboidisch. Abstandhalter, Entretoise en losange, Separador romboidal	Th=5 mm S 235 JR
574	<b>Tubo corrimano rettangolare</b> Rectangular handrail tube, Rechteckiges Handlaufrohr, Rambarde tubulaire rectangulaire, Tubo pasamanos rectangular	120x80x5 L=4480 mm S 275 JR
903	<b>Palo in tubo con piastra</b> Rectangular tube post with base plate, Vierkantrohrsteher mit Grundplatte, Poteau tubulaire avec plaque, Poste de tubo con placa	120x80 Th=5 H=1500 mm S 235 JR
18	<b>Fascia 3 onde</b> 3-waves beam, 3-wellige Leitschiene, Glissière 3 ondes, Banda triple onda	L=4816 (1500x3) Th=3 mm S 235 JR

### Caratteristiche Characteristics, Eigenschaften, Caractéristiques, Características

<b>Altezza barriera</b> Barrier height, Höhe Leitplanke, Hauteur glissière de sécurité, Altura barrera	1510 mm
<b>Profondità d'infissione tirafondi</b> Depth of anchor bolts penetration, Einschraubtiefe der Verankerungen, Prondeur de vissage des ancrages, Profundidad de anclaje varilla roscada	200 mm
<b>Ingombro trasversale</b> Overall width, Gesamtbreite, Grosseur hors tout, Anchura total	500 mm
<b>Interasse pali</b> Post spacing, Steherabstand, Distance entre poteaux, Distancia entre postes	1500 mm

### Rapporti di prova Crash test reports, Testberichte, Comptes rendus d'essais, Relaciones de pruebas

Test n.	Facility	Test	Type	Barrier length m	Mass kg	Speed km/h	ASI max 1.4	THIV max 33 km/h	D m	Vi m	W m
PROVA 688	Aisico	TB81	Laterale 20°	99	38.000	65	-	-	1	1,6	1,5=W5
PROVA 671	Aisico	TB11	Laterale 20°	99	900	100	1=A	25	0,2	-	0,6=W1